

## XPX – EXPANSION JOINT GRADE JOINT BAND

[www.gripset.com](http://www.gripset.com)

TECHNICAL DATA SHEET

[techenquiries@gripset.com](mailto:techenquiries@gripset.com)



### Description

The Elastoproof XPX Jointing Band is an innovative, detailing system designed for waterproofing and sealing high movement and expansion joints. Constructed of heavy duty NBR rubber, the XPX Jointing band system is a simple yet highly effective, long term sealing system.

### Features & Benefits

- \* Heavy duty rubber construction providing for high elongation and expansion properties
- \* Highly durable
- \* Time saving simplified installation
- \* Long term protection at critical joint intersections and movement zones
- \* Accommodates movement in longitudinal and lateral directions with up to 100% elastic recovery

### Application

- \* The Elastoproof XPX Joint Band is suitable for use over high movement and expansion joints for industrial and commercial applications.

### Priming

- \* The Elastoproof XPX Jointing band must be applied onto a primed surface
- \* Apply Gripset P10 Primer extending 100mm out from edges of joint to total length.
- \* Coverage of P10 Primer to be applied at 1litre per 6m<sup>2</sup>. Allow P10 Primer to dry for minimum 24 hours before XPX Joint Band installation

### Foam Rod

- \* Foam backing rod to be inserted into joint prior to Elastoproof Joint Band installation.

### Fixing Joint Band

- \* Apply Elastoproof HV Adhesive to sides of joint in line with outer perforations of the XPX Joint Band.
- \* Embed XPX Joint Band into wet adhesive layer allowing adhesive to push through perforated edge.
- \* Smooth adhesive using spatula or similar over joint band perforations ensuring adequate adhesive build/saturation.

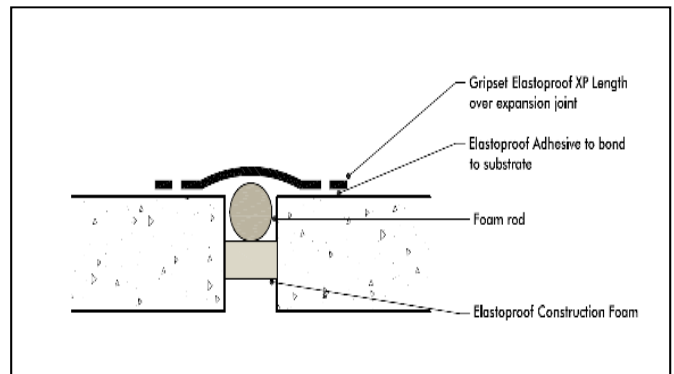

### Joint Band Overlaps

- \* Lengths of XPX Jointing Band are to be overlapped a minimum of 50mm.
- \* Once overlapped a 200mm section of XPX Joint Band is to be cut and perforations formed using hole punch or similar around edges.
- \* Fix reinforcement Joint Band over overlapped section using Elastoproof HV Adhesive.

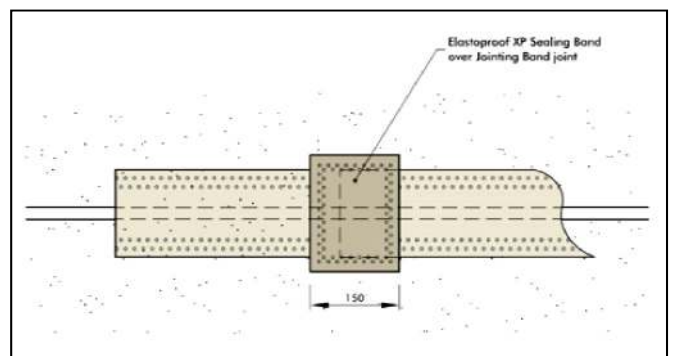
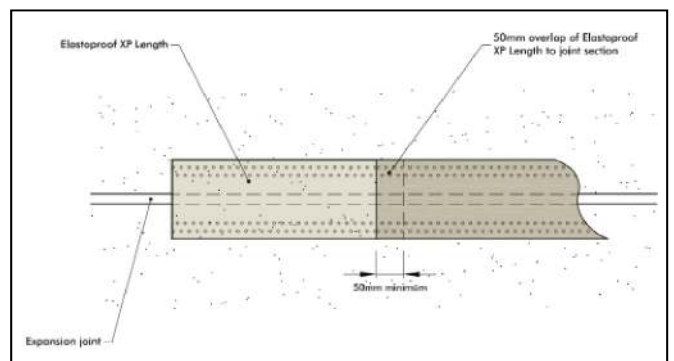

## XPX – EXPANSION JOINT GRADE JOINT BAND

[www.gripset.com](http://www.gripset.com)

TECHNICAL DATA SHEET

[techenquiries@gripset.com](mailto:techenquiries@gripset.com)

### Joint Intersections

Prefabricated items are available for placement directly over joint intersections. Available in "T", "+" and "L" designs the prefabricated sections are fixed to the substrate using the Elastoproof HV Adhesive. Lengths of the XPX Jointing Band are overlapped onto the prefabricated sections a minimum of 75mm and fixed using Elastoproof HV Adhesive

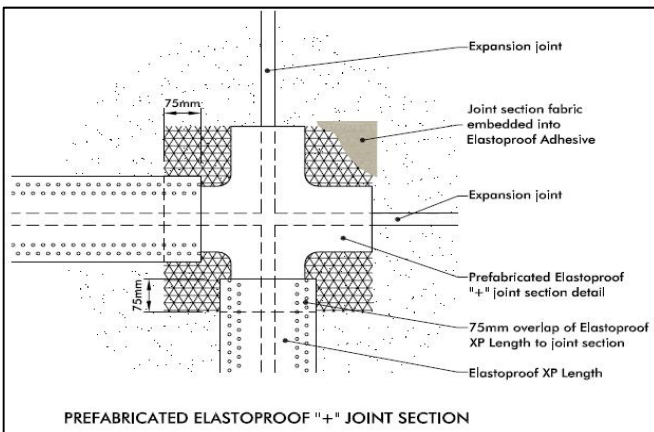

### Protective Finishes

- \* Protective metal ramping is to be installed over the Elastoproof XPX Joint band system for areas exposed to vehicular traffic
- \* For areas subject to UV exposure, contact the Technical Department of Gripset Industries

### Packaging

- \* 50m Roll length

### Precautions

- \* Not compatible with solvent based materials, e.g. adhesives, sealants or coatings
- \* Not to be used as UV exposed joint seal in external applications
- \* Do not apply when surface temperature is below 5°C or above 30°C.
- \* For further information about this product contact technical department of Gripset Industries.

### Product Properties

Rubber	NBR (acrylonitrile butadiene rubber)
Carrier Edging:	Perforated NBR
Total Width:	200mm
Thickness:	1.2mm
Rubber width:	160mm span & central stretch zone
Material weight:	250g/m
Surface face:	NBR

### Physical Properties

Shore A hardness:	65
Temperature resistance:	-20°C to 90°C
Tensile strength (DIN 53504):	11.6 N/mm <sup>2</sup> lateral direction 10.7 N/mm <sup>2</sup> longitudinal direction
Rupture strain (DIN 53504):	389% lateral direction 404% longitudinal direction
Moisture vapour transmission	<0.227g/24h/m <sup>2</sup>
Equivalent air thickness sd:	5.0
Water pressure resistance:	3 bar
Fire class (DIN, EN):	B3, F

### Chemical Resistance

Lactic acid:	5%
Acetic acid:	5%
Hydrochloric acid:	3%
Chloric acid :	3%
Sulphuric acid:	35%
Citric acid:	10%
Potassium hydroxide:	20%
Sodium hypochlorite:	(0.3g/L)
Sea water:	sea salt (20g/L)
Lime milk:	pH 12.5
Sodium hydroxide solution:	pH 14
Diesel oil, grease, oil, paraffin:	0 to 14pH

### Movement Parameters

Starting Joint Width	100mm (maximum)
Movement capacity	No more than 50% of starting joint width

## XPX – EXPANSION JOINT GRADE JOINT BAND

[www.gripset.com](http://www.gripset.com)

TECHNICAL DATA SHEET

[techenquiries@gripset.com](mailto:techenquiries@gripset.com)

### Notes

Elastoproof products are to be installed to manufacturer guidelines using recommended Elastoproof or Gripset membranes/adhesives. No warranty is offered when these products are not installed to specification. Details contained in this product data sheet are general. For any situation or items not covered in this data sheet, it is the responsibility of the applicator to check with Gripset Technical Services **before** commencing the application. A written confirmation will then be issued by Gripset Technical Services.

### Gripset Industries Pty Ltd

ABN: 64 137 930 093

Telephone: +61 (8) 8124-7300 or 1800 650 435

Email: [techenquiries@gripset.com](mailto:techenquiries@gripset.com)

Website: [www.gripset.com](http://www.gripset.com)

### Product Disclaimer

This Product Data Sheet (PDS) summarises our best knowledge of the product, including how to use and apply the product based on the information available at the time. You should read this PDS carefully and consider the information in the context of how the product will be used, including in conjunction with any other product and the type of surfaces to, and the manner in which, the product will be applied. Our responsibility for products sold is subject to our standard terms and conditions of sale. Gripset Industries does not accept any liability either directly or indirectly for any losses suffered in connection with the use or application of the product whether or not in accordance with any advice, specification, recommendation or information given by it.